

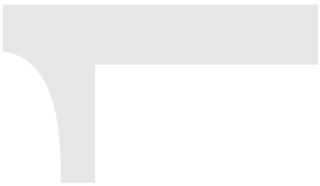

B BERGARN[®]
OUR BARRELS MAKE THE DIFFERENCE

B-14

OWNER'S MANUAL
MANUAL DE USUARIO



CONTENTS

EN

1. Introduction	4
2. General safety	5-6
3. Before firing the rifle	7
4. Loading the rifle	8
5. Loading the ammunition into a detachable magazine	8
6. Functioning of detachable magazine system	9
7. Assembly of detachable magazine kit	9
8. Firing the rifle	10-11
9. Breaking in the barrel	12
10. Removing a bullet stuck in the bore	12
11. Use of military ammunition	12
12. Trigger pull adjustment	13
13. Testing a trigger setting for safety	14
14. Maintenance of the trigger	14
15. Mounting the scope	14-15
16. Field strip	15
17. Cleaning and maintenance	16-17
• Barrel	16
• Receiver and bolt	17
• Stock and forend	17
18. Storage	17
19. B14 BMP model	18-19
• Stock regulation	18
• Loading the rifle	19
20. B14 BMP model description	20-21
21. B14 HMR model	24
• Stock regulation	18
• Loading the rifle	19
22. B14 HMR model description	24
23. FAQs, causes and solutions	18-21
24. General description	22-23
25. Warranty	24

1. INTRODUCTION AND GENERAL SAFETY

Thank you for buying a Bergara B14 bolt action rifle.

We hope that this firearm is up to your expectations, serves you as intended and gives you years of satisfaction.

Please read this manual. There are many features that the user must familiarize with to safely use this firearm.

The future of shooting sports depends on you.

Accidents, misuse of firearms etc. are portrayed as reasons to ban shooting sports in general and firearms in particular. Please be responsible, promote safety and listen to safety advices from other fellow shooters.

If after reading the instructions, warnings and risks detailed in this manual you are not ready to accept the responsibility involved in handling and shooting a firearm safely, return the gun to where you bought it.

All security measures should be taken into account for the safe use of the firearm.

2. GENERAL SAFETY

10 Safety rules for handling your firearm

- 1 Always keep the muzzle pointed in a safe direction, even when the rifle is unloaded.
- 2 Be sure of your target and of what is behind it before aiming at anything.
- 3 Never trust the mechanical safety catch of a firearm.
- 4 The firearm must be unloaded until the moment of use.
- 5 Always use eye and ear protection.
- 6 The barrel must be free from any obstruction before loading and firing.
- 7 Handle every firearm as if it were loaded.
- 8 Store firearms and ammunition separately and in an enclosed, locked area.
- 9 Avoid the consumption of alcohol and drugs before and while using a firearm.
- 10 Do not alter or modify your firearm. Make sure your firearm is serviced regularly by a competent gunsmith. Make sure all the parts are working properly before each use.

2. SAFETY CONSIDERATIONS FOR ALL FIREARMS

- Never smoke while you are shooting or handling a firearm or related material. The ashes or sparks can ignite the gunpowder or cartridges, causing personal injury or death.
- Always use eye protection. It is possible that sparks fly from the breech or the muzzle when we use a rifle.
- Always check the rifle before using it to ensure it is in good working order. Test the trigger and the release system carefully before loading. Make sure that the barrel is not obstructed. Any obstruction can cause the barrel to rupture, resulting in serious injury or death.
- Never load a firearm until you are ready to shoot. You must remove the cartridge when walking, climbing trees or fences, passing the firearm from one person to another, jumping a wall or fence, etc.
- Never lean a firearm against a wall, a tree, a vehicle or any other surface. If a loaded firearm falls it may cause the weapon to accidentally fire, causing serious injury or death.
- Never transport a loaded firearm in any type of vehicle. The firearm is considered to be loaded all the while that the cartridge remains in the chamber.
- Never store a loaded firearm. The firearm must be unloaded and cleaned before any type of storage.
- Never load a firearm without first ensuring that the barrel is clean and unobstructed. If the firearm falls to the floor by accident, check that the barrel has not become obstructed.
- Be very careful when hunting from a position in a tree. If a loaded firearm accidentally falls it may cause the weapon to fire, causing serious injury or death. Make sure the firearm is unloaded before climbing up or down from a tree.
- Never trust the mechanical safety catch! Mechanical devices can and do fail. Firearms must always be handled as if they were ready for shooting, regardless of the position or the mechanical condition of the safety catch.
- Always follow the proper cleaning procedures. Shooting a firearm that is poorly maintained or corroded can lead to dangerous pressure and/or cause the barrel to explode, causing serious injury or death.
- Never point the barrel at anything you do not wish to see damaged. When carrying the firearm on your shoulder, make sure that the barrel is pointing upwards.
- Never try to modify the inner parts of your firearm. Doing so may cause a dangerous situation, provoking an accidental discharge of the weapon and causing serious injury or death. These alterations will generally void the warranty.
- Never leave the firearm unattended or in the reach of children. In some countries it is punishable by law.

3. BEFORE FIRING THE RIFLE

Familiarize yourself with the rifle. Learn how it works and how to use it without ammunition.

Recommendations before using the rifle:

- The rifle comes packed with the bolt detached from the action. Before assembling the bolt, check that the rifle is not loaded, i.e. that there is no casing in the chamber or obstruction in the bore.
- Make sure that there is no cartridge in the magazine.
- Clean the barrel on the inside as shown in the section on “cleaning and maintenance”.
- Wipe off the excess oil from the bolt and the receiver area.
- Insert the bolt into its action as shown under “dismantling of the firearm components for cleaning purposes” in this manual.
- Check the trigger for proper function by dry firing several times.
- After completing the above steps, you can load the firearm as shown in the following section of this manual.
- The first time a firearm is fired, it is recommended to break in the barrel. This process is described in the section “Breaking in the barrel”.

4. LOADING THE RIFLE

The B14 is used as follows:

Load the magazine from the upper side with the correct ammunition. Push the cartridge down into the magazine (Fig. 4.1) and pull it back when it is inside (Fig. 4.2). The capacity of the magazine is 4 cartridges + 1 in the chamber for standard calibers and 3 cartridges + 1 in the chamber for magnum calibers. If these actions are not performed correctly you may have problems with the performance of the rifle.

Safety advice:

Double check that the ammunition being loaded is the correct type. The barrel of the rifle has the caliber marked on the side. Shooting ammunition of a different caliber to that marked on the barrel is very dangerous and can cause very serious accidents.

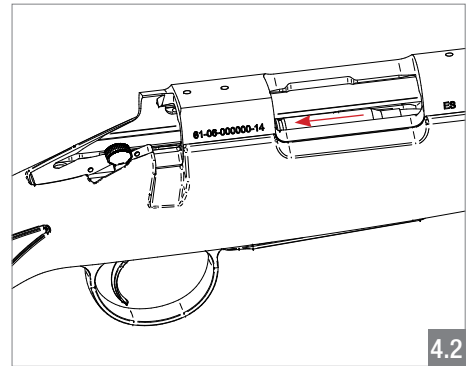
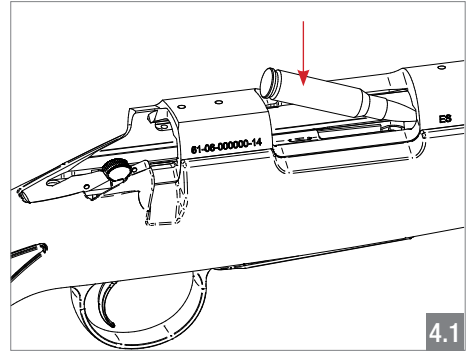

5. LOADING THE AMMUNITION INTO A DETACHABLE MAGAZINE

Load the magazine from the upper side with the corresponding ammunition. Push the cartridge down (Fig. 5.1) and once it leans on the front side of the magazine slide it back (Fig. 5.2). The capacity of the magazine is 3 cartridges for standard calibers and 2 cartridges for magnum calibers. Functioning problems may happen if these steps are not followed.

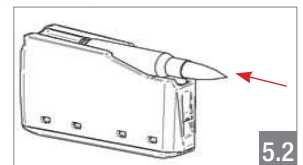
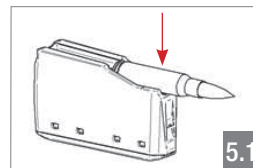

6. FUNCTIONING OF DETACHABLE MAGAZINE SYSTEM

To install the magazine push it to the top, inside the trigger guard, being the ammunition exit side up. (Fig. 6.1)

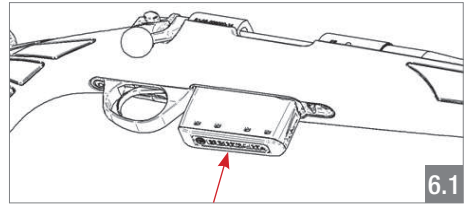

To release the magazine pull the lever located on the front side of the trigger guard. (Fig. 6.2)

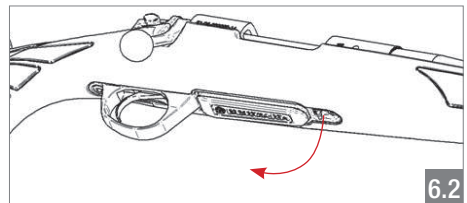

EN

7. ASSEMBLY OF DETACHABLE MAGAZINE KIT

A detachable magazine kit is available for floor plate B14 rifles. Follow the following steps for the correct assembly of this kit.

- Unscrew the floorplate and extract it with all its pieces. (Fig. 7.1)

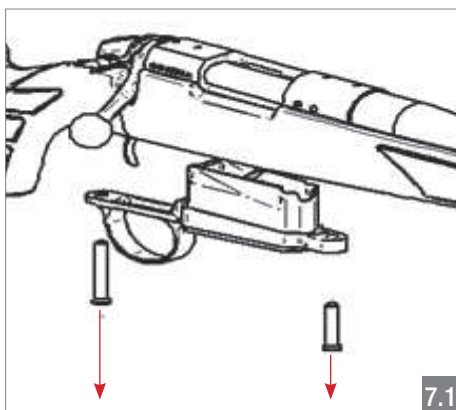

- Install the new trigger guard and screw it to the rifle with the screws supplied in this kit (Fig. 7.2). The torque for these screws 6,2Nm (55lbs in).
- Install the magazine in the trigger guard.

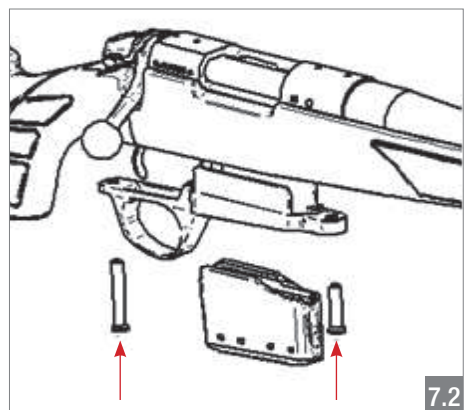

8. FIRING THE RIFLE

- Remove the bolt and make sure the firearm is not loaded. Also verify that nothing is obstructing the bore. Make sure the magazine floor plate is closed.
- The safety catch cannot be activated if the bolt handle is in the down position and the firing pin is not cocked. Having lifted the bolt handle you can now activate the safety catch of the rifle. Therefore, put the safety catch on once the bolt handle is up and before inserting a bullet into the chamber. The rifle is put into the safe position by pushing the safety catch back, towards the white dot. (Fig. 8.1)
- Close the bolt. Check the red cocking indicator. (Fig. 8.2)

Safety advices:

When you load the firearm make sure you have lowered the bolt handle right down to the stop.

*If you close the bolt and the cocking indicator does not protrude, do not use the rifle. Take the firearm to a qualified gunsmith or contact **Bergara Customer Service**.*

- When you are ready to shoot, disengage the safety catch (lever forward) and gently pull the trigger.

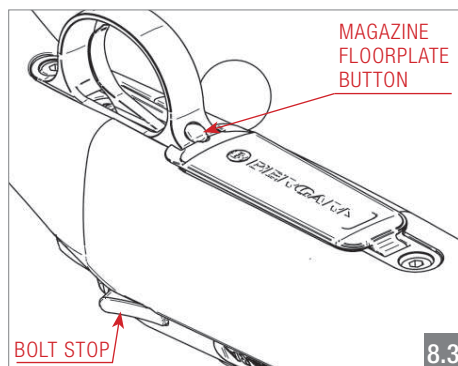
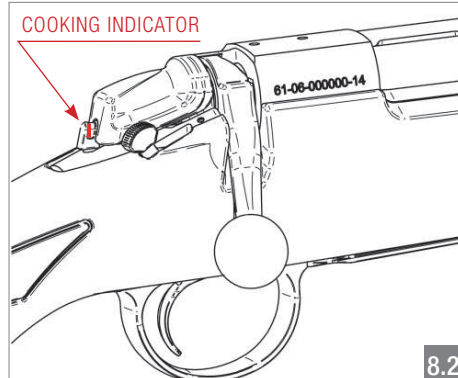
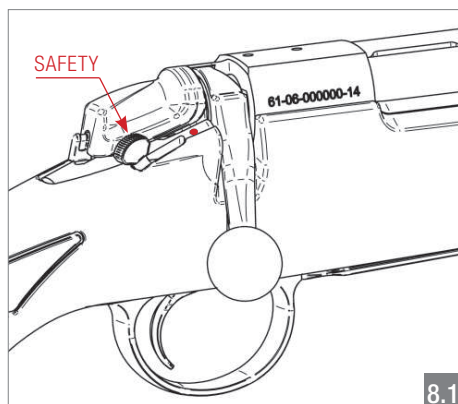

8. FIRING THE RIFLE

Safety advices:

If on pulling the trigger of a loaded firearm the rifle does not fire, point the rifle in a safe direction and wait 30 seconds before opening the bolt. The bolt must be opened very carefully.

*If you suspect you have made a defective shot and that the bullet has not left the barrel, remove the bolt and check it. This situation can occur because the gunpowder has deteriorated, does not burn or only partially burns. Take the rifle to a qualified gunsmith or contact **Bergara Customer Service**.*

- Once fired, open the bolt, pull back as far as the stop, then push forward and close

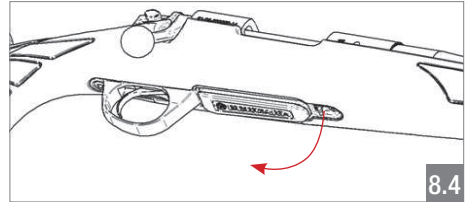

the bolt. Make sure the rifle ejects the used cartridge. It is important to pull the bolt all the way back and not just a short way as this could jam the firearm.

- To empty the ammunition from the firearm, remove the bolt from receiver and then remove the ammunition by pressing the button on the magazine floorplate (**Fig. 8.3**) or remove the detachable magazine. (**Fig. 8.4**)
- Make sure that there is no cartridge in the chamber.

EN

9. BREAKING IN THE BARREL

During manufacturing, microscopic imperfections are created in the bore of the barrel. These imperfections are smoothed after several rounds of shots. If these imperfections are removed correctly, the barrel will foul less, will be easier to clean, will be more uniform and will become more accurate.

The process of removing these imperfections is called "Breaking in the barrel". The process involves firing a shot or a series of shots and then cleaning the bore.

Allow the barrel to cool down before you start cleaning.

Recommended breaking in process:

- For the first 5 shots clean the rifle after each shot.
- For the next 50 shots clean the rifle after every 10 shots.
- For subsequent shots clean the rifle frequently.

10. REMOVING A BULLET STUCK IN THE BORE

Safety advice: Do not try to remove the bullet that is stuck by firing again, because the pressure created can destroy the firearm

injuring the shooter. Take this to a qualified gunsmith or contact **Bergara Customer Service**.

11. USE OF MILITARY AMMUNITION

Military ammunition, such as the 5.56 NATO and 7.62 NATO, is not completely interchangeable with commercial ammunition, such as the .223 Remington and .308 Winchester. There are other differences in the dimensions

of the chamber and the pressure with which the ammunition is usually loaded.

Therefore BERGARA and the SAAMI do not recommend using military ammunition in civilian firearms.

12. TRIGGER PULL ADJUSTMENT

The B14 features a fully adjustable trigger mechanism. The trigger pull is pre-set at the factory at about 1.3 kg (2.8 lbs) on HMR-BMP models and 1.5 kg (3.3 lbs) on hunting models. The possible adjustment is from around 1.3 kg (2.8 lbs) to 1.8 kg (3.9 lbs) on HMR-BMP models and from around 1.5 kg (3.3 lbs) to 2kg (4.4 lbs) on hunting models.

Safety advices:

Do not change the trigger mechanism for one made by another manufacturer. It may fit in your firearm but it may not work properly, causing it to be unsafe. The replacement of the firing mechanism voids the warranty.

The trigger must be adjusted by a qualified gunsmith or the factory only.

- To access to the adjustment screw you will have to remove the stock. To do this, release the magazine tray and unscrew the screws of the trigger guard (**Fig. 12.1**). When removing the stock it can become jammed in the receiver and removing it may take a while.
- The adjusting screw for trigger pull (**Fig. 12.2**) adjusts the force required to pull the trigger.

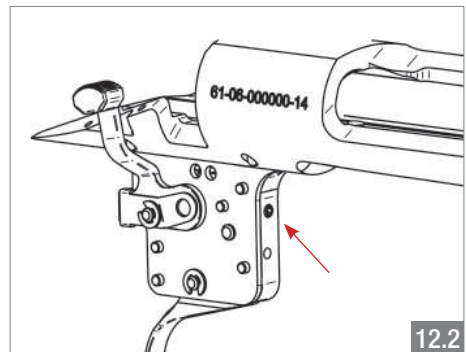
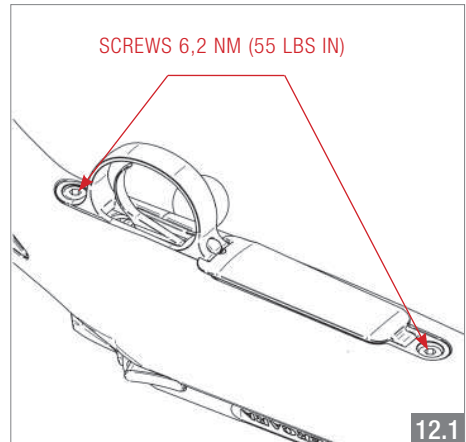

Safety advice:

A trigger that is too light can cause an accidental discharge.

Do not touch any other screws since it can be dangerous.

13. TESTING A TRIGGER SETTING FOR SAFETY

After having the trigger adjusted the following tests should be made:

- Close the bolt as fast as possible. The cocking indicator should remain visible. If this is not the case, contact Bergara Customer Service.
- Check the trigger pull with a trigger pull weight scale. If the trigger pull weight is

less than 1kg (2.2lbs), increase the trigger pull.

- Simulate a shot and do a full cycle. The red cocking indicator should be visible. If not, contact technical service.

Safety advice:

Never perform these tests with the firearm loaded.

14. MAINTENANCE OF THE TRIGGER

The trigger must be lubricated periodically for proper conservation.

We recommend to spray a thin liquid lubricant. Do not use solid lubricants such as vaseline.

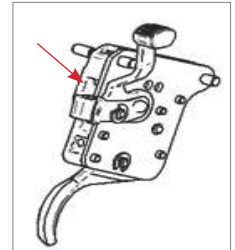
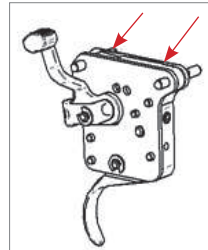

15. MOUNTING THE SCOPE

The receiver has 4 threaded holes. Commercially available scope bases suitable for the Remington® 700™ rifle will fit the BERGARA B14. Use rings of appropriate height.

When you install the scope ring or rail, we recommend using a thread locking product comparable to Loctite® 242. This will prevent the scope from loosening over time due to the recoil.

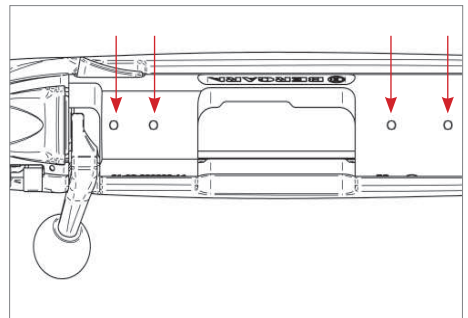

15. MOUNTING THE SCOPE

To install the scope, follow the instructions provided by the scope manufacturer.

Make sure you use the proper length screws for the scope mounts. The screws should not protrude inside the receiver. The rear screws are sometimes longer than front screws. Changing the position of these screws may cause problems the performance of the rifle.

Safety advice:

Always wear protective glasses when firing. Do not install the scope too close to the eye. Due to the recoil the scope can hit the shooter's face and cause injury. As practical advice, check that your fist can fit between your eye and the scope. If the eye relief is too short, replace it for one with greater eye relief.

EN

16. FIELD STRIP

To dismantle the gun for cleaning or inspection, take the following steps (Fig. 16.1) :

- Unload the rifle by releasing the floorplate or remove the detachable magazine.
- Position the bolt about 25 mm (1 inch) before the stop.
- Push the release of the retractable stop and remove the bolt.

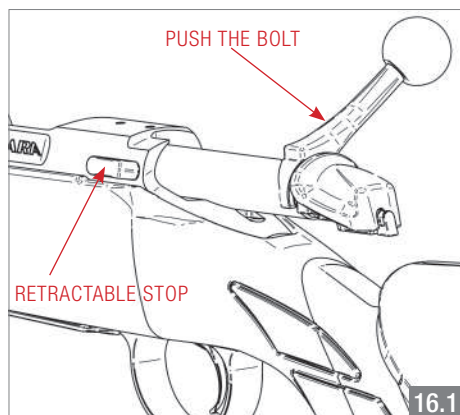

- Verify there is no cartridge in the chamber or the bore, looking through the barrel from the chamber side.

To assemble the dismantled rifle (Fig. 16.2) :

- Press the release of the retractable stop and insert the bolt. Rotate the bolt until it aligns with the channel.
- Make sure the floorplate is closed, if not, close it.

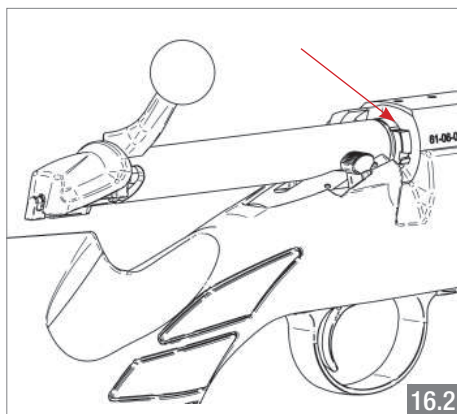

17. CLEANING AND MAINTENANCE

In general, the B14 rifle is easy to maintain. In this section you will find all the information required to keep the rifle in good shape.

After firing a shot with the rifle, if it is not cleaned properly within 24 hours corrosion will start to appear in some of the components of the firearm. In humid environments the appearance of corrosion is even more likely than in normal conditions.

EN

We therefore recommend that you clean the following parts regularly, especially after a day of hunting or on the shooting range (always refer to the instructions provided by the manufacturer of the chemical products used):

Barrel

The high quality of the Bergara rifle barrel requires proper care to maintain its accuracy. This advice should be followed:

- The correct direction for cleaning is from the chamber to the muzzle. Cleaning the barrel in the opposite direction seriously affects the accuracy.
- If possible, use a quality, one piece cleaning rod to avoid damaging the bore.
- Use suitable cleaning products to help prolong the life of the barrel.
- Try to avoid the accumulation of too much copper in the bore. It will significantly reduce the accuracy.
- Use a high quality brush for cleaning the bore. Avoid stainless steel brushes.
- It is highly recommended to also clean the chamber. Use a suitable brush.
- After cleaning the bore, apply a patch (a cloth square) soaked in gun oil to prevent rust. Run a dry cloth through it before shooting to remove the oil and not damage the bore.

Important: Traces of oil inside the barrel at the moment of firing can cause overpressure.

- Check the crowning regularly for damage because this can seriously affect the accuracy.

Receiver and bolt

- Clean the entire bolt and the inside of the receiver with a cloth impregnated with a suitable product to remove residues.
- Using a brush, clean the bolt face and extractor. Also clean the exposed area of the firing mechanism and the bolt head lugs.
- The body of the bolt, the lugs, the cocking channel and the safety catch must be lubricated or greased. Periodically, a drop of suitable oil should be placed on the ejector and the extractor (*Fig. 17.1 y 17.2*), until we get a very thin film of oil.

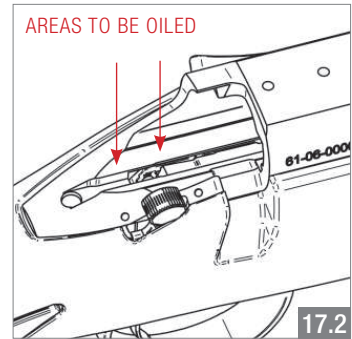
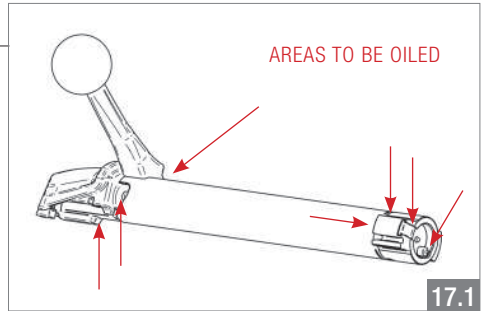

Stock

- A fine brush can be used to remove dust from the outside.
- The synthetic stock is easily cleaned with a damp microfiber cloth.
- The wooden stock has been treated with oil at the factory. Generally speaking it is only necessary to dry it after use, however, to keep it in good condition it is desirable to occasionally apply a good stock oil.
- After cleaning, lubricate all the exposed metal parts of the rifle.

18. STORAGE

- Store your gun in a safe including a method for reducing the relative humidity.
- From time to time, remove the rifle from its storage location and clean it.
- Follow the legal regulations regarding storage of firearms.
- If you are going to keep the rifle in the gun rack for an extended time, store it uncocked, with the firing pin spring in the resting position, i.e. not compressed.

19. B14 BMP MODEL

The BMP (Bergara Mach Precision) stock has been manufactured from aeronautic 7075 aluminum to ensure the correct performance during the use. This section contains the details you need to know about the BMP stock.

Stock regulation

EN

BMP stock has 3 adjustment systems that allows the user to adapt it to physical complexion and the shooting position of the shooter.

- The check piece is easily adjustable in height. Turn the regulation screw to the left to free the check piece, move the check piece to the position needed and tighten screw to lock the system again. To place the check piece in the same position after pulling it completely out the front guide has groves for circlip. (Fig. 19.1)
- This rifle has 5 options for length of pull. Turn the regulation screw to the left to free the system, move the recoil pad to the best of 5 positions and then lock the system turning the regulation screw to the right. (Fig. 19.2)
- The orientation and height of the recoil pad can be adjusted for the user need. Turn the knob to the left to free the recoil pad, put it in the correct position and turn the screw to the right to lock the system again. (Fig. 19.3)

The BMP stock allows to assembly some AR-15 components on it:

- Grip.
- Rear (assembling an adapter).
- Many accessories (picatinny rails, bipod...)

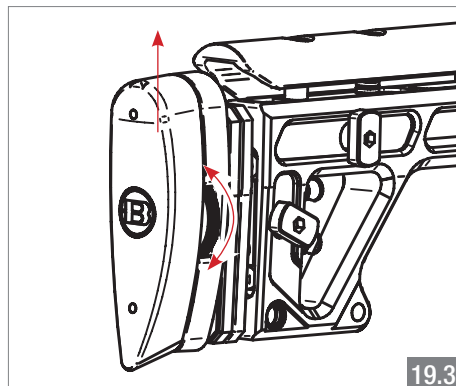
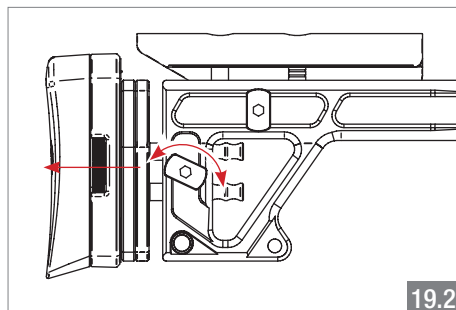
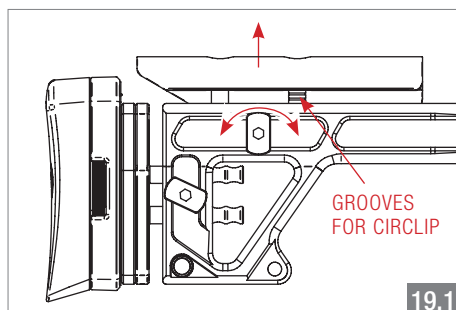

19. B14 BMP MODEL

Loading the rifle

The B14 BMP magazine is loaded as follows:

- Load the magazine from the top with the correct ammunition. Push the cartridge down into the magazine (Fig. 19.4) and slide it completely to the rear (Fig. 19.5). Repeat this step until the magazine is full. The capacity of the magazine is 5 cartridges + 1 in the chamber. If these steps are not performed correctly you may have problems with the performance of the rifle.

Safety advice:

Double check that the ammunition being loaded is the correct type. The barrel of the rifle has the caliber marked on the side. Shooting ammunition of a different caliber to that marked on the barrel is very dangerous and can cause very serious accidents.

- To install the magazine insert it completely into the magazine well. Rotate the magazine to the rear until you hear and feel the magazine catch lever engage. (Fig. 19.6)
- To release the magazine push the lever located at the front of the trigger guard. (Fig. 19.7)

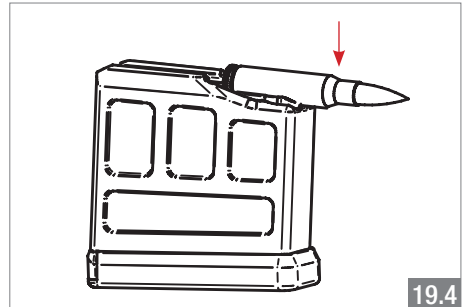

19.4

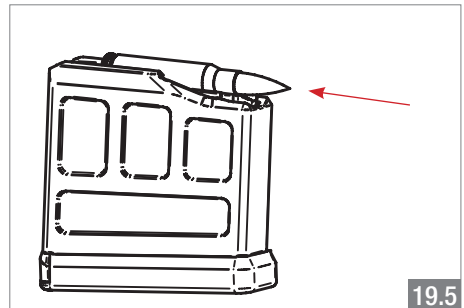

19.5

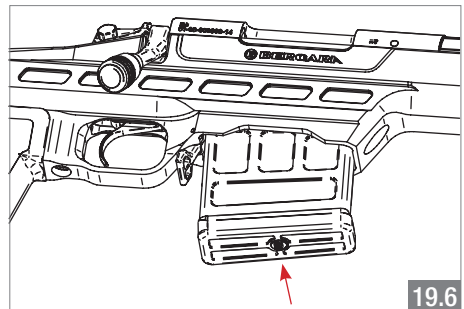

19.6

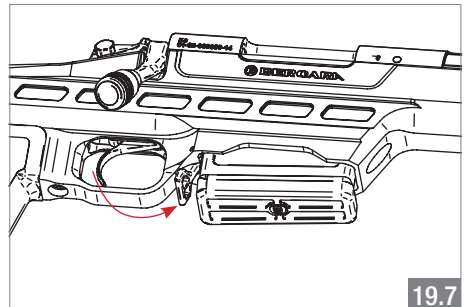

19.7

20. B14 BMP DESCRIPTION

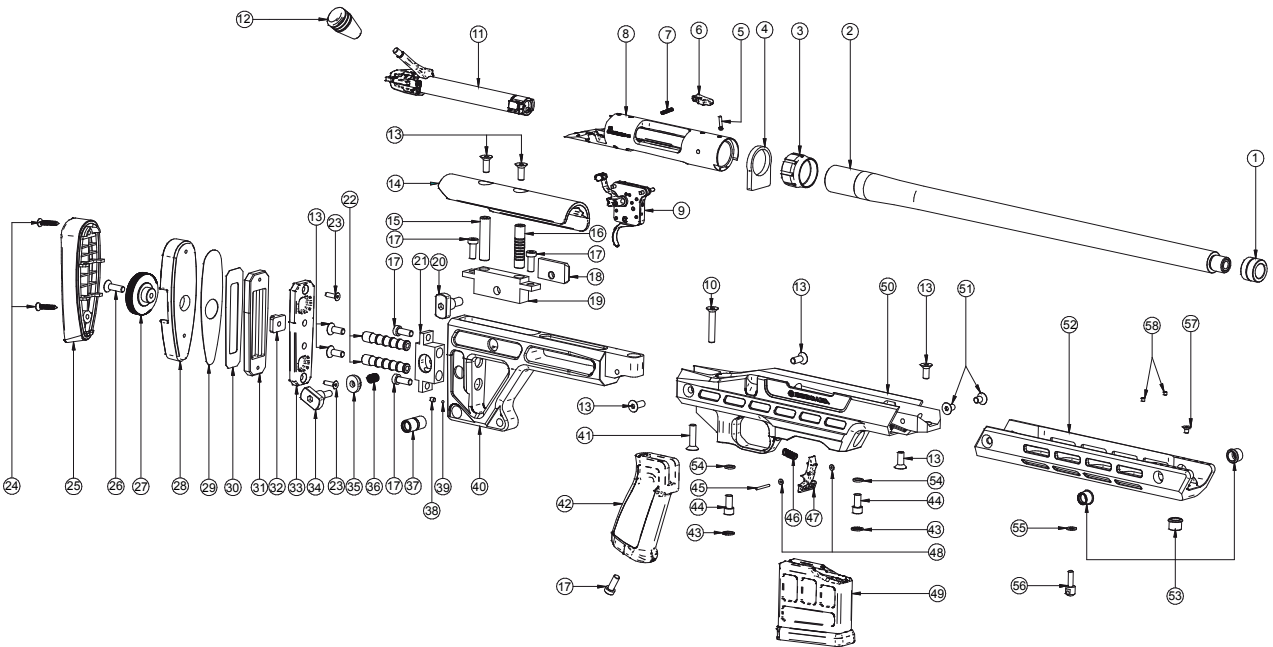

20. B14 BMP DESCRIPTION

ITEM N.	DESCRIPTION	ITEM N.	DESCRIPTION
1	Thread cup	30	Rubber sticker for guide
2	Barrel	31	Regulation knob guide
3	Barrel nut	32	Recoil pad regulation nut
4	Recoil lug	33	Guides support
5	Bolt catch screw	34	Recoil pad regulation screw
6	Bolt catch lever	35	Recoil pad regulation nut
7	Bolt catch spring	36	Recoil pad regulation spring
8	Receiver	37	Sling swivel
9	Trigger mechanism	38	Threaded pin
10	Stock screw	39	Ball
11	Bolt body assembly	40	Rear part
12	Bolt knob	41	Fixing screw
13	Check piece screw	42	Pistol grip
14	Check piece	43	Screw stop
15	Check piece rear guide	44	Fixing screw
16	Check piece front guide	45	Lever pin
17	Support fastening screws	46	Lever spring
18	Check piece regulation nut	47	Lever
19	Check piece guides support	48	Lever ring
20	Check piece regulation screw	49	Magazine
21	Support for recoil pad guides	50	Central part
22	Recoil pad guide	51	Fixing screw
23	Fixing screw	52	Forehand
24	Recoil pad screw	53	Sling swivel
25	Recoil pad	54	Washer
26	Recoil pad regulation screw	55	Plastic washer
27	Recoil pad regulation knob	56	Front sling swivel
28	Recoil pad support	57	Sling swivel screw
29	Rubber sticker for support	58	Threaded pin

21. B14 HMR MODEL

The HMR (Hunting Mach Rifle) rifle with its internal aluminum skeleton stock is the perfect gun for long range hunting, long range target shooting and competition use. This section contains the details you need to know about the HMR stock.

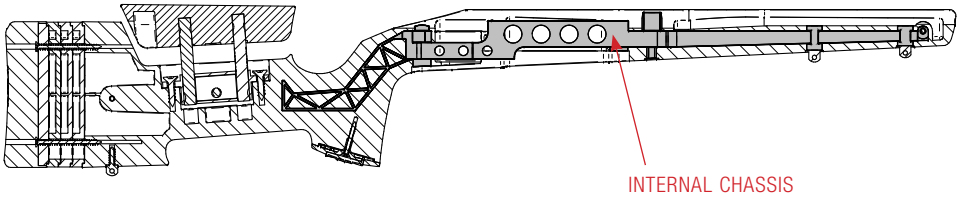

Stock regulation

HMR stock has length regulation and check piece regulation system that allows the user to adapt it to the physical complexion and shooting position of the shooter.

- The check piece is easily adaptable in height. Turn the regulation screw to the left to free the check piece, move the check piece to the position needed and turn right the screw to tie the system again. To place the check piece in the same position after pulling it completely out the front guide has grooves for circlip. (Fig. 21.1)
- This rifle has 4 options of length. You can take out spacers to make it shorter or you can add them to make the stock longer. Untie recoil pad screws until the spacers are free, turn the spacers to take them out and tie the screws again (Fig. 21.2)

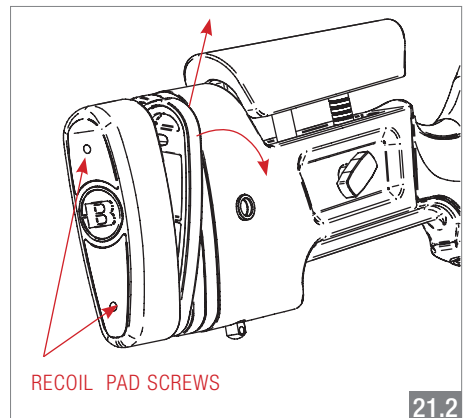
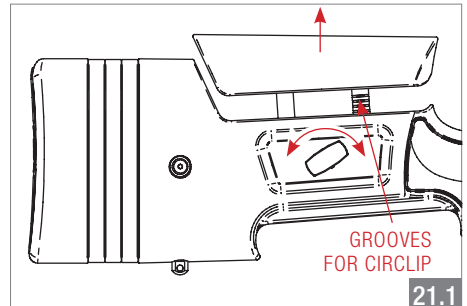

21. B14 HMR MODEL

Loading the rifle

The B14 HMR magazine is loaded as follows:

- Load the magazine from the top side with the correct ammunition. Push the cartridge down into the magazine (Fig. 21.3) and slide it completely to the rear (Fig. 21.4). Repeat this step until the magazine is full. The capacity of the magazine is 5 cartridges + 1 in the chamber. If these steps are not performed correctly you may have problems with the performance of the rifle.

Safety advice:

Double check that the ammunition being loaded is the correct type. The barrel of the rifle has the caliber marked on the side. Shooting ammunition of a different caliber to that marked on the barrel is very dangerous and can cause very serious accidents.

- To install the magazine insert it completely into the magazine well. Rotate the magazine to the rear until you hear and feel the magazine catch lever engage. (Fig. 21.5)
- To release the magazine, push the lever located on the rear side of the trigger guard. (Fig. 21.6)

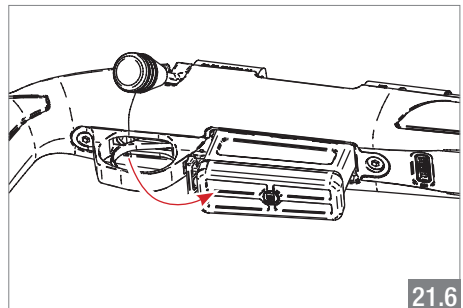
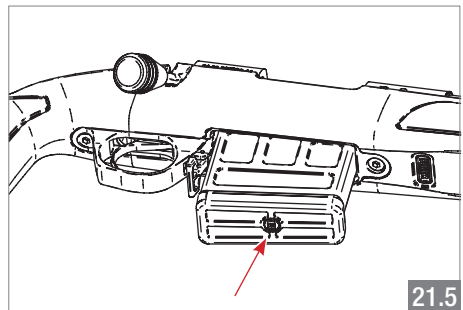
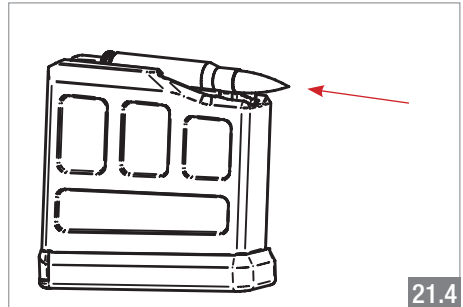
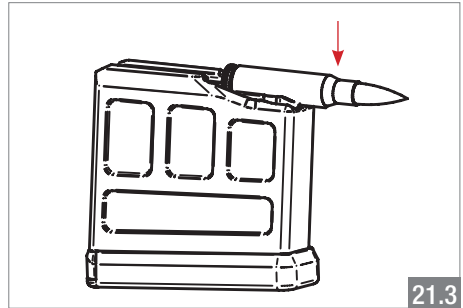

22. B14 HMR DESCRIPTION

EN

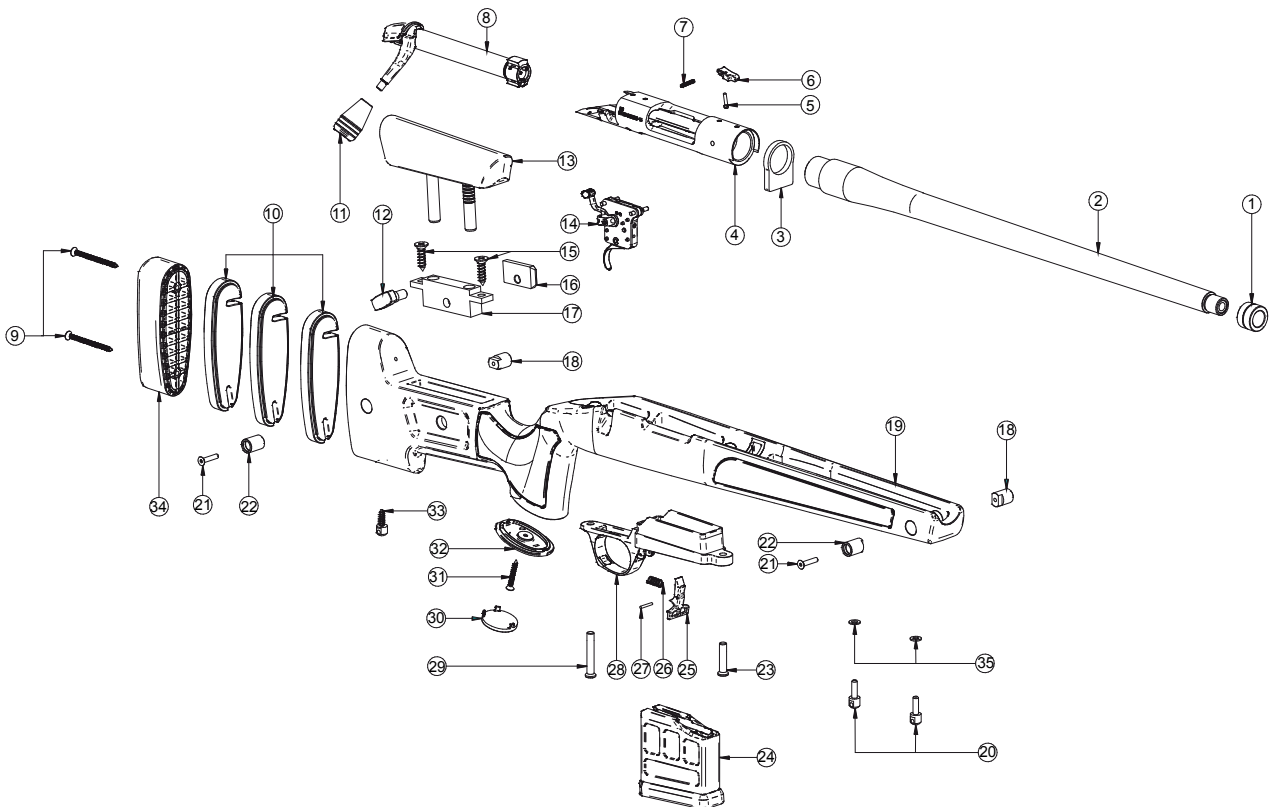

22. B14 HMR DESCRIPTION

ITEM N.	DESCRIPTION	ITEM N.	DESCRIPTION
1	Thread cup	19	Stock
2	Barrel	20	Front sling swivel
3	Recoil lug	21	Sling swivel screw
4	Receiver	22	Right sling swivel
5	Bolt catch screw	23	Stock front screw
6	Bolt catch lever	24	Magazine
7	Bolt catch spring	25	Lever
8	Bolt body assembly	26	Lever spring
9	Recoil pad screw	27	Lever pin
10	Recoil pad spacers	28	Trigger guard
11	Bolt knob	29	Stock rear screw
12	Check piece regulation screw	30	Shield cover
13	Check piece	31	Shield fixing screw
14	Trigger mechanism	32	Shield
15	Support screw	33	Rear sling swivel
16	Check piece regulation nut	34	Recoil pad
17	Support for the guide	35	Plastic washer
18	Left sling swivel		

EN

23. FAQs, CAUSES AND SOLUTIONS

PROBLEM	CAUSE	SOLUTION
The firearm is loaded, I pull the trigger but the shot doesn't fire	Defective ammunition	Try with different ammunition
	The firing pin does not go out far enough or it does with little force	Contact Bergara Customer Service
	Broken firing pin	
The cartridge does not fit in the chamber	Ammunition incorrect caliber	Make sure the ammunition is the correct calibre
	The case is stuck	Very carefully remove the lodged casing
	Something is obstructing the chamber or chamber is very dirty	Carefully clean the chamber
	Chamber is damaged	Contact Bergara Customer Service
I can't lower the bolt handle	Chamber dirty (casing residual...)	Clean it, If not resolved, contact Bergara Customer Service
	You have used different caliber ammunition	Use correct ammunition
	Ejector locked, rigid	Apply oil, move by hand. If not resolved, contact Bergara Customer Service
The rifle fires when closing the bolt	Damaged trigger or improper trigger adjustment	Stop immediately, very dangerous
The rifle fires when safety catch on	Be careful! Very dangerous. Defective trigger	Contact Bergara Customer Service
The rifle has been fired but the casing doesn't eject	The extractor does not work properly	Contact Bergara Customer Service
		Check that the extractor "springs" correctly
		Check that the extractor is not broken
		If it is either of these things, return the rifle to the factory
	Defective casing	Try with different ammunition
	Chamber damaged	Contact Bergara Customer Service

23. FAQs, CAUSES AND SOLUTIONS

PROBLEM	CAUSE	SOLUTION
I cannot insert the cartridges into the magazine	Follower incorrectly positioned	Position the follower correctly
	Cartridges wrongly inserted	When inserting the cartridge you must ensure that the base touches the back part of the magazine. That is, the cartridge must be pushed downwards and backwards as shown on p. 8 of this manual
	Incorrect calibre of ammunition	Make sure the calibre corresponds to the barrel
The rifle fired, the casing extracted but wasn't expelled	Dirt or rust in the ejector	Clean adequately and lubricate the area
	The ejector does not work properly	Check that the ejector "springs" correctly and isn't blocked Check that the extractor operates correctly If either of these things doesn't work, contact Bergara Customer Service
I cannot open the floorplate of the magazine	Dirty or poorly maintained	Clean, then lubricate the area with spray-on oil
I cannot close the floorplate of the magazine	Damage in follower or spring	Contact Bergara Customer Service
The rifle does not feed the cartridges from the magazine	Dirty or poorly maintained	Clean, then lubricate the area with spray-on oil
	Damage in follower or spring	Contact Bergara Customer Service
	Cartridges wrongly inserted in magazine	Remove the cartridges and reload the magazine making sure that the bullets are correctly inserted according to p. 8 of this manual
	Damage in follower or spring	Contact Bergara Customer Service

23. FAQs, CAUSES AND SOLUTIONS

PROBLEM	CAUSE	SOLUTION
The bolt comes out without pressing the bolt stop	The bolt stop or spring is broken	Contact Bergara Customer Service
Rear cap rotated	Accidental turning when the bolt is back or removed	Rotate the cap into position by hand
The trigger is very stiff	Improperly adjusted, dirty or poorly maintained	Adjustment of the trigger by a qualified gunsmith or contact Bergara Customer Service
The bolt movement is very stiff	Dirt, inadequate lubrication	Remove the bolt and carefully clean the bolt and action
	Bolt damaged	Contact Bergara Customer Service
My rifle is rusting	Inadequate maintenance of the rifle	Remove Rust and then oil or Contact Bergara Customer Service
It is difficult to raise the bolt handle	Dirty or poorly maintained	Clean and lubricate adequately
	Inappropriate ammunition that causes overpressure	Use commercial ammunition
	Problem in the rifle mechanism	Contact Bergara Customer Service
The ball of the bolt handle is loose	Broken thread	Contact Bergara Customer Service
	Loose from its housing	Use a thread locking product to reseal the ball

EN

23. FAQs, CAUSES AND SOLUTIONS

PROBLEM	CAUSE	SOLUTION
The rifle does not group my shots	Inappropriate ammunition	Try with different ammunition
	Reloaded ammunition	
	Have you dropped the rifle?	Check the condition of the weapon and the scope. If everything is OK and it doesn't group, return to the factory for damage assessment and warranty
	Dirt or rust in the barrel (especially near the muzzle)	Clean the barrel properly according to this instruction book
	Dirt in the chamber	
	Scope badly fitted (base, rings, display)	Ensure that the sighting systems are properly fitted with a 7 Nm torque
	Blow to the muzzle (crowning)	Contact Bergara Customer Service
	Accessories fitted on the barrel (except open sights or scope)	Remove the accessories that have been fitted to the barrel
	Barrel is touching the stock	Contact Bergara Customer Service
	The stock is badly fitted	Ensure that the screws are secure
	The trigger release is very stiff	Contact Bergara Customer Service
	Chamber damaged	
	Defective closure bolt-action-barrel	

EN

24. GENERAL DESCRIPTION

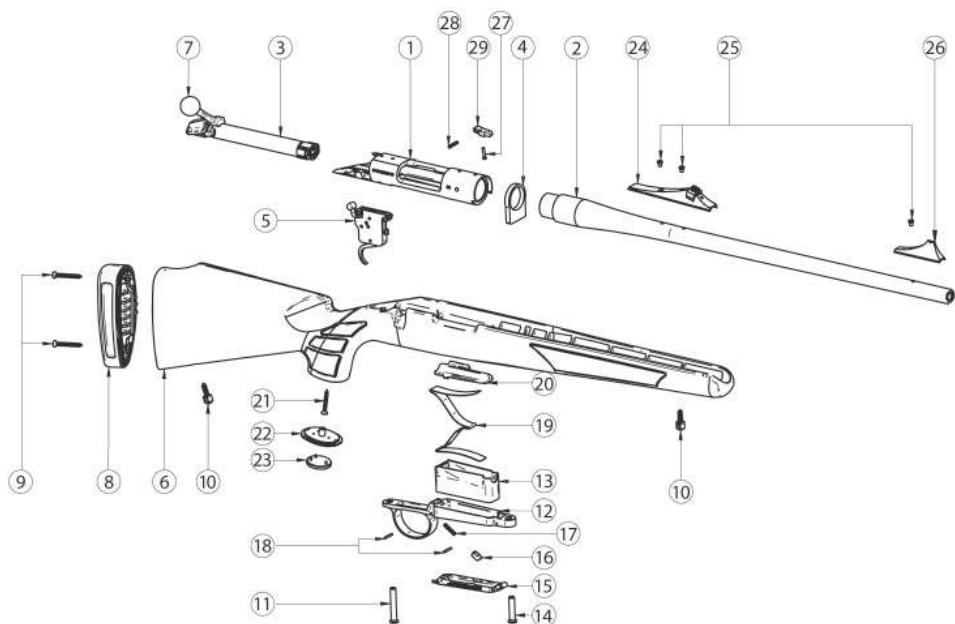

ITEM N. DESCRIPTION

ITEM N. DESCRIPTION

1	Receiver	16	Magazine opening button
2	Barrel	17	Opening button spring
3	Bolt body assembly	18	Trigger guard lock pins
4	Recoil lug	19	Magazine spring
5	Trigger mechanism	20	Follower
6	Stock	21	Shield fixing screw
7	Bolt knob	22	Shield
8	Recoil pad	23	Shield cover
9	Recoil pad screws	24*	Rear sight
10	Sling swivel	25*	Sight screws
11	Stock rear screw	26*	Front sight
12	Trigger guard	27	Bolt catch screw
13	Magazine	28	Bolt catch spring
14	Stock front screw	29	Bolt catch lever
15	Magazine tray		

** Sights are only available in Europe*

EN

24. GENERAL DESCRIPTION

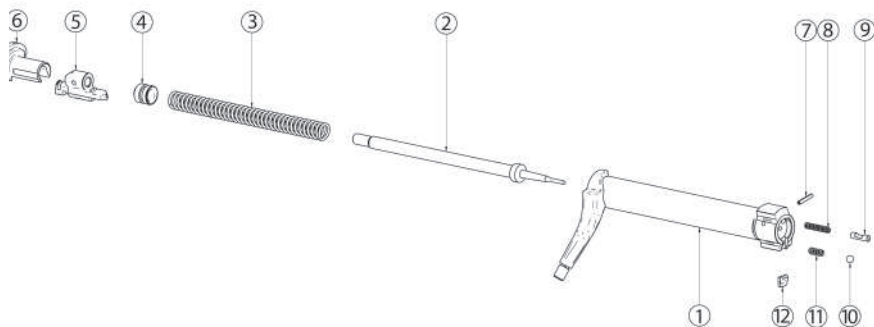

EN

ITEM N.	DESCRIPTION	ITEM N.	DESCRIPTION
1	Bolt body	7	Ejector pin
2	Firing pin	8	Ejector plunger spring
3	Firing pin spring	9	Ejector
4	Firing pin bushing	10	Extractor ball
5	Firing pin lock	11	Extractor spring
6	Firing pin shroud	12	Extractor

ITEM N. DESCRIPTION

1	Trigger guard lock pins
2	Lever spring
3	Magazine clamping lever
4	Magazine trigger guard
5	Magazine pushing plate
6	Regulation screw
7	Pushing pin
8	Pushing spring
9	Stock front screw
10	Stock rear screw
11	Magazine body
12	Follower
13	Magazine sheet of metal
14	Magazine spring
15	Magazine plate

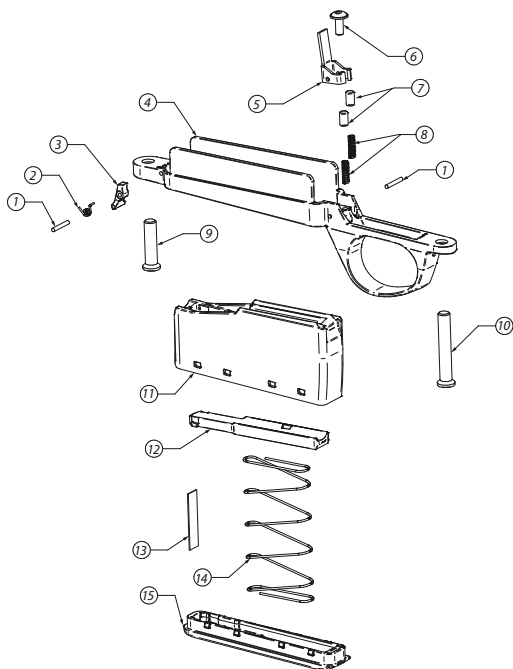

25. WARRANTY

Please address your warranty concerns electronically to:

Info@bergararifles.com

For USA /Canada:

contact@bergarausa.com

Or by mail to:

Bergara North America

BPI Outdoors

1270 Progress Center Ave. Suite 100

Lawrenceville, GA 30043

EN

The Bergara B14 rifle is warranted to be free from manufacturers defects for the life of the gun. This warranty is to the original purchaser and is not transferable. This warranty does not cover normal wear and tear, finish of metal or wood, abuse or misuse, damage to property, cost of inconvenience or loss of use.

This warranty gives you certain legal rights and you may have other rights which vary from state to state or country to country. Apart from the assumptions of cancellation of warranty mentioned in the different sections of this manual, below will also void the warranty:

- Unauthorized modifications and/or repairs.
- Rifle returned in neglected conditions (dirty, corroded, etc.).
- Use of improper ammunition (e.g. military ammunition, reloaded ammunition, ammunition un authorized by CIP or SAAMI).
- Damages which result from not following the instructions given in this manual.

The rifle is identified by its serial number on the side of the receiver.

IMPORTANT: In case of return, make sure that the rifle is unloaded!!



CUSTOMER SERVICE USA/CANADA:

EN

Bergara North America

BPI Outdoors
1270 Progress Center Ave. Suite 100
Lawrenceville, GA 30043

800 320-8767

www.bergarusa.com
contact@bergarusa.com

Facebook: Bergara USA

Youtube: Bergara US





BERGARA[®]
OUR BARRELS MAKE THE DIFFERENCE

BERGARA NORTH AMERICA

BPI Outdoors
127 Progress Center Ave. Suite 100
(Lawrenceville, GA 30043)

www.bergarausa.com
contact@bergarausa.com

 Bergara USA

 Bergara US

 bergara_rifles

 bergarausa